

**CONVENTION HALL LVL PLAN
SCALE 1:100**

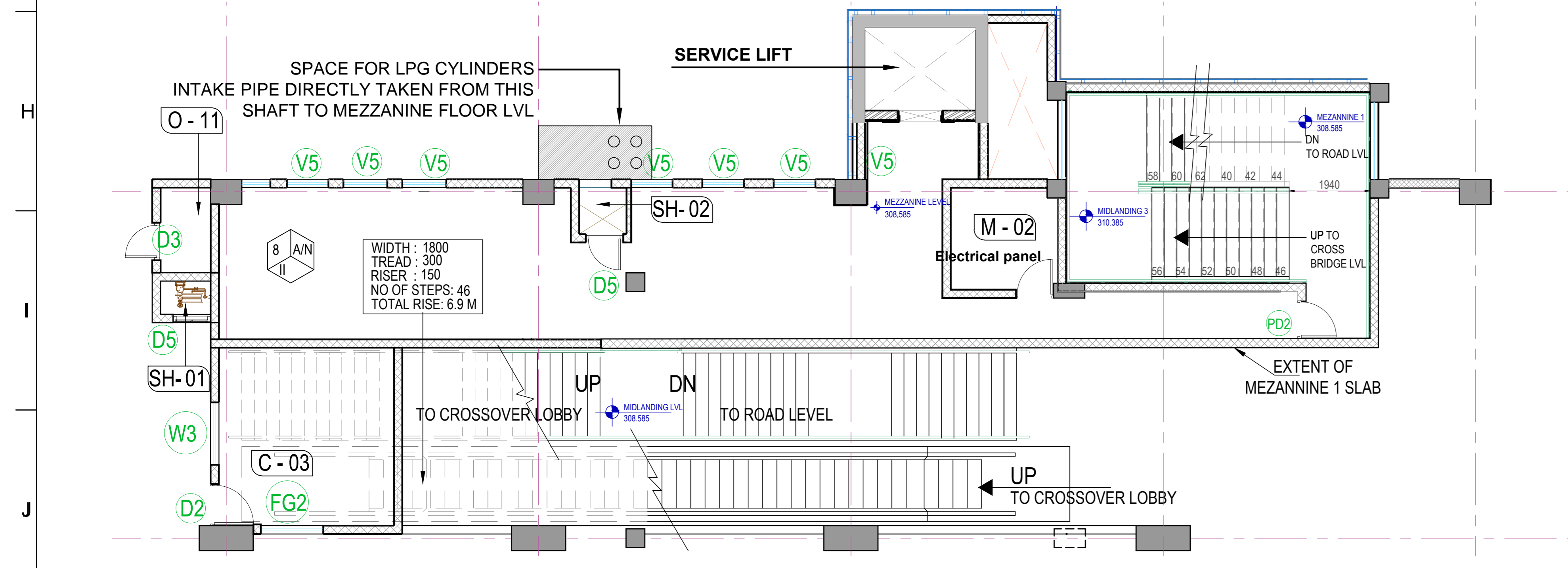

**MEZZANINE LVL PLAN
SCALE 1:100**

NOTES:
1. CROSS CHECK THE DIMENSION MENTION IN THE DRAWING ACCORDING TO SITE

NOTES:

- ALL DIMENSIONS ARE IN MM
- ALL LEVELS IN METERS FROM MEAN SEA LEVEL UNLESS OTHERWISE MENTIONED
- DIMENSIONS ARE NOT TO BE SCALED. ONLY WRITTEN DIMENSIONS SHALL BE FOLLOWED
- ALL DIMENSIONS ARE INDICATIVE AND ARE SUBJECT TO CHANGE DURING DETAILED DESIGN.
- GRID DIMENSIONS FROM CENTER TO CENTER OF COLUMN

REV NO	DATE	DESCRIPTION	SIGN
1			
2			
3			
4			
5			
6			
7			
8			
9			
10			
11			
12			
13			
14			
15			
16			

THE RESPONSIBILITY OF CONTROL, CHECK & VERIFICATION OF ACCURACY, CORRECTNESS, COMPLETENESS, INTEGRATION & FULL COMPLIANCE OF THE CONTRACT PROVISIONS IN RESPECT OF DESIGN, ANALYSIS AND DRAWINGS RESTS WITH THE DETAILED DESIGN CONSULTANT / DETAILED DESIGN CONSULTANT & CONTRACTOR. IT IS CERTIFIED THAT THERE IS NO CHANGE IN THIS GCD FROM THE ALREADY APPROVED OR DWG NO. REV. APPROVED ON DATE			
DDC / CONTRACTOR		CONTRACTOR / DDC	
SIGN:	SIGN:	SIGN:	SIGN:
DATE: 03.02.2020	DATE: 03.02.2020	DATE: 03.02.2020	DATE: 03.02.2020
NAME: DB	NAME: VP	NAME: AJ	NAME: ...
DRAWN BY	DESIGN BY	CHECKED BY	APPROVED BY
consortium of enia, mahendra raj & worxpace			
KG-1/265, Vikasपुरी, New Delhi, India Tel: +91 9971 691803 / +91 9818 629588 s.manohanda@enia.in / a.joshi@enia.in www.enia.in		Sub-consultants: AECOM ADS Manycor	

THIS DRAWING INCLUDING ITS DESIGN AND DETAILING HAS BEEN **PROOF CHECKED** INDEPENDENTLY AND FOUND SUITABLE FOR THE EXECUTION PURPOSE AND IS RECOMMENDED FOR GFC / NO OBJECTION.

THIS DRAWING INCLUDING ITS DESIGN AND DETAILING HAS BEEN **PROOF CHECKED/REVIEWED** AND FOUND SUITABLE FOR THE EXECUTION PURPOSE AND ISSUED AS 'GOOD FOR CONSTRUCTION' BEING GIVEN NO OBJECTION

SYSTRA-AECOM-EGIS-RITES
Church House, Above SBI Bank,
First floor, Civil Lines Nagpur- 440001

COUNTER SIGNED BY MAHARASHTRA METRO RAIL CORPORATION LTD.

PROJECT:	NAGPUR METRO RAIL PROJECT Metro House, 28/2, CK Naidu Marg, Anand Nagar, Civil Lines, Nagpur - 440 001 Phone No: 07122554217
CLIENT:	MAHARASHTRA METRO RAIL CORPORATION LTD.
LOCATION:	
TITLE:	
SCALE:	DATE: STATUS:
DRG NO:	R1D06-ENI-AR-PRM-SAT-DRP-0101
REVISION NO:	

ARCHITECTURE